

NOVA LUCE

9186974

1

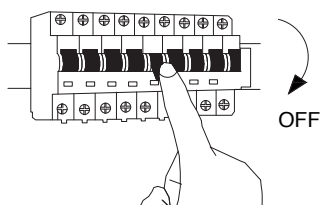

Turn off the general switch

2

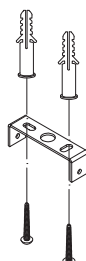

Drill holes & apply plastic anchors
With screws

3

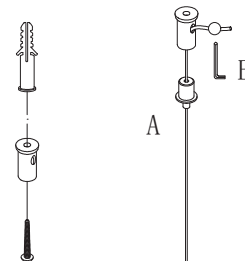

Apply the hanging element

4

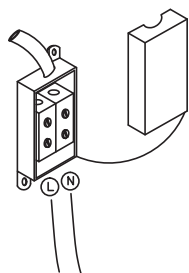

Connect the wires

5

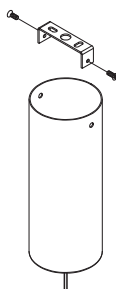

Apply the side screws

6

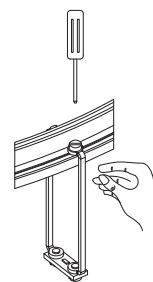

When the frames or LEDs are not straight, please
loosen one screw and straighten them by
hand, then tighten the screw.

7

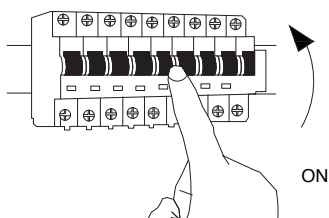

Turn on the general switch

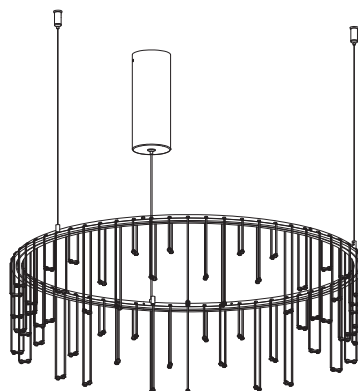

- a) This light fitting operates at a normal supply voltage of 220-240V.
- b) When changing the bulb or fuses, always switch off at the mains and allow the old bulb to cool down before handling.

www.novaluce.com